

PLANTING NOTES

Native Buffer Planting Mix (Southern, Eastern & Northern Boundaries)
'Woodland Edge' Mix
 The selection of native species for new planting areas and for reinforcing existing vegetation to be retained and for the creation of new areas would include those found on the Site and surrounding area including:

- 25% Hawthorn (*Crataegus monogyna*)
- 15% Hazel (*Corylus avellana*)
- 15% Holly (*Ilex aquifolium*)
- 15% Field maple (*Acer campestre*)
- 10% Crab apple (*Malus sylvestris*)
- 10% Common privet (*Ligustrum vulgare*)
- 5% Dogwood (*Cornus sanguinea*)
- 5% Wild plum (*Prunus domestica*)
- Honeysuckle (*Lonicera periclymenum*)*

Planting stock would be a mix of 75% 60-80cm bare root 1+1 transplants or containerized depending on species and 25% feathered stock (typically 1.5-1.75m high range). Planting density to be 1no./m2 planted in single species groups of 7-15no.

*Indicates species to be interplanted within mix at c.1no. plant/2m2.

In addition, a number of larger specimen trees (12-14cm girth + / rootballed or containerised depending on species) would be included in key areas to provide a degree of initial impact including the following species:
 - Beech (*Fagus sylvatica*)
 - Quercus robur (Oak)
 - Field maple (*Acer campestre*)
 - Crab apple (*Malus sylvestris*)
 - Wild cherry (*Prunus avium*)

Beech and oak would be planted along the A272 to continue the existing line of trees along this corridor.

All planting areas would be protected with rabbit / shelter guards as required and fenced off with strained post and wire fencing where required until planting has become established.

Proposed Grassland Habitat
 The creation of areas of species-rich calcareous grassland is proposed along the verges of the proposed internal access routes (c.4m wide), as well as a broad marginal area along the northern boundary (c.10m wide).

These areas would be created using stored topsoil taken from the Site. A suitable prescribed seed mix of UK origin would be used to achieve good establishment.

Vegetation would be managed by cutting once / twice per year with the arisings removed to prevent weed species becoming dominant.

A 1m wide mown strip would be cut more regularly adjoining access routes to maintain a neat and tidy appearance.

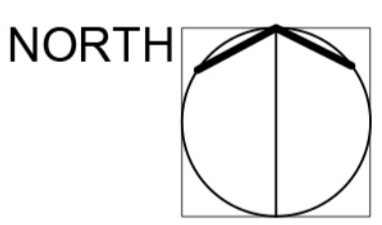

For sections please refer to Typical Sections drawing J00546-021

GROUNDWORKS AND TOPSOIL HANDLING NOTES

All groundworks and handling of subsoil and topsoil materials to be carried out in accordance with 'Construction Code of Practice for the Sustainable Use of Soils on Construction Sites' (DEFRA, 2009).

Construction of bunds to comprise inert free-draining material as core fill. Materials to be loosely placed to avoid compaction to ensure that trees and shrub planting can establish successfully.

- Depths of soil materials for landscape areas as follows:
- Grass areas: 150mm
 - Tree and shrub planting: 400mm

An area of bare ground using site-won chalk substrate is proposed to allow natural colonisation and provide valuable habitat for invertebrates. Therefore, this area will not receive topsoil materials

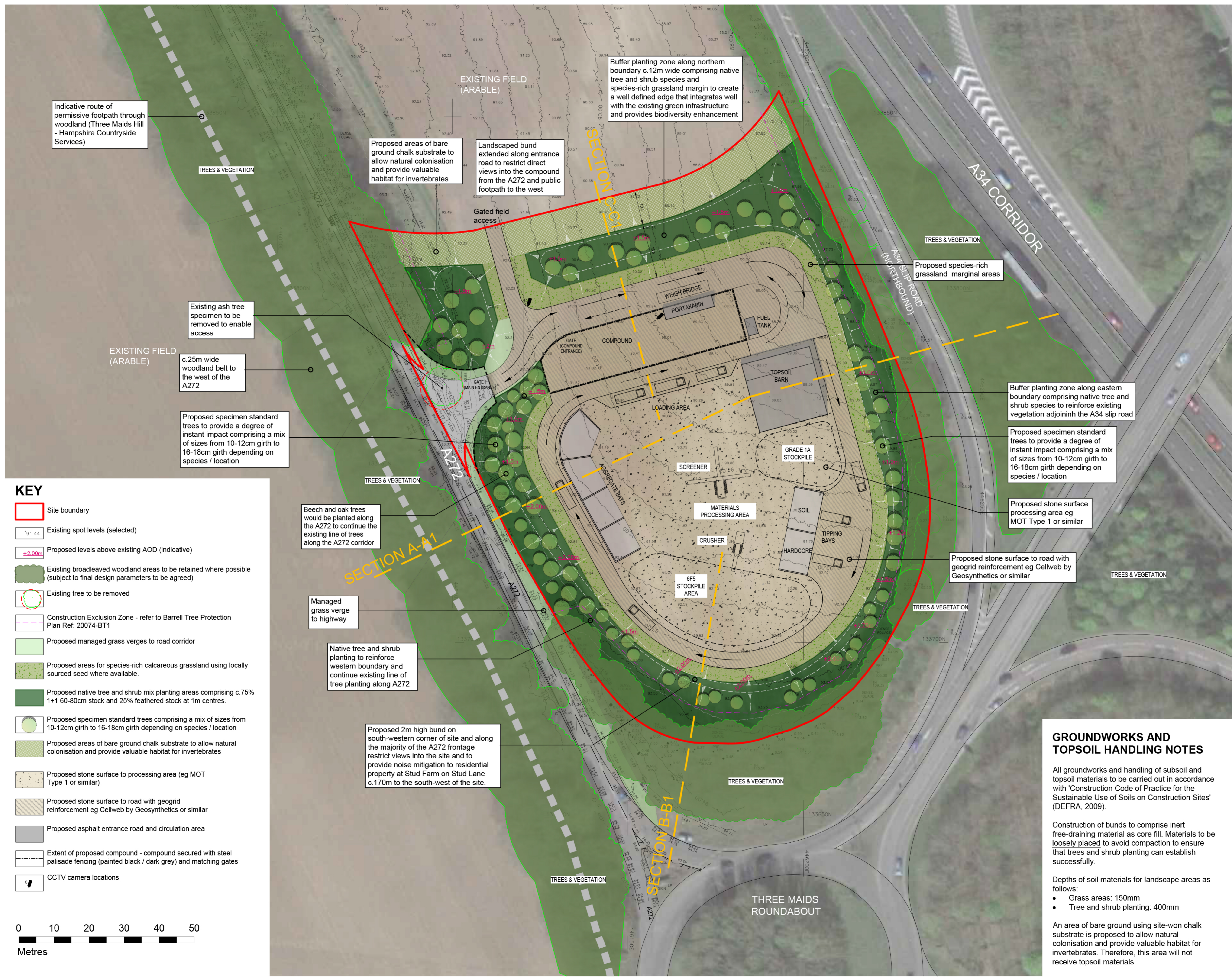

Indicative route of permissive footpath through woodland (Three Maids Hill - Hampshire Countryside Services)

Proposed areas of bare ground chalk substrate to allow natural colonisation and provide valuable habitat for invertebrates

Landscaped bund extended along entrance road to restrict direct views into the compound from the A272 and public footpath to the west

Buffer planting zone along northern boundary c.12m wide comprising native tree and shrub species and species-rich grassland margin to create a well defined edge that integrates well with the existing green infrastructure and provides biodiversity enhancement

Existing ash tree specimen to be removed to enable access

c.25m wide woodland belt to the west of the A272

Proposed specimen standard trees to provide a degree of instant impact comprising a mix of sizes from 10-12cm girth to 16-18cm girth depending on species / location

Proposed species-rich grassland marginal areas

Buffer planting zone along eastern boundary comprising native tree and shrub species to reinforce existing vegetation adjoining the A34 slip road

Proposed specimen standard trees to provide a degree of instant impact comprising a mix of sizes from 10-12cm girth to 16-18cm girth depending on species / location

Proposed stone surface processing area eg MOT Type 1 or similar

Proposed stone surface to road with geogrid reinforcement eg Cellweb by Geosynthetics or similar

Beech and oak trees would be planted along the A272 to continue the existing line of trees along the A272 corridor

Managed grass verge to highway

Native tree and shrub planting to reinforce western boundary and continue existing line of tree planting along A272

Proposed 2m high bund on south-western corner of site and along the majority of the A272 frontage restrict views into the site and to provide noise mitigation to residential property at Stud Farm on Stud Lane c.170m to the south-west of the site.

KEY

- Site boundary
- Existing spot levels (selected)
- Proposed levels above existing AOD (indicative)
- Existing broadleaved woodland areas to be retained where possible (subject to final design parameters to be agreed)
- Existing tree to be removed
- Construction Exclusion Zone - refer to Barrell Tree Protection Plan Ref: 20074-BT1
- Proposed managed grass verges to road corridor
- Proposed areas for species-rich calcareous grassland using locally sourced seed where available.
- Proposed native tree and shrub mix planting areas comprising c.75% 1+1 60-80cm stock and 25% feathered stock at 1m centres.
- Proposed specimen standard trees comprising a mix of sizes from 10-12cm girth to 16-18cm girth depending on species / location
- Proposed areas of bare ground chalk substrate to allow natural colonisation and provide valuable habitat for invertebrates
- Proposed stone surface to processing area (eg MOT Type 1 or similar)
- Proposed stone surface to road with geogrid reinforcement eg Cellweb by Geosynthetics or similar
- Proposed asphalt entrance road and circulation area
- Extent of proposed compound - compound secured with steel palisade fencing (painted black / dark grey) and matching gates
- CCTV camera locations

